

Section 4: Changing Your Master Password (Optional)



How to change the master password to your 1Password account.

If you find the password created for your account to be too difficult to remember or type, you have the option of changing your password to something else. However, you should keep in mind that there are certain requirements for what the new password can be — which you'll see in a later step.

For this guide to work, you must already have your password, be signed into the macOS 1Password app, and be signed into the 1Password app on your iPhone.

Note...

Recording Your Password...

It's fairly straightforward to change your master password for your 1Password account. However there is an added complication that you must also record that change in the 1Password Item in your Vault. If the new password is not recorded correctly, it may cause problems in the future. But one benefit of recording it in the 1Password Item is the optional use of the password generator built into the 1Password app. You will see this in later steps. This section will guide you through the process of changing your password and adding it to the 1Password Item in your Vault.

Be Aware of Time... ? ??

It is recommended that you read through this entire section first before proceeding with following the steps. Because the 1Password website will sign you out if inactive for 10 minutes, it can cause frustration if the process is not completed within that time limit. It is also recommended that you read [Section 8](#) (particularly on **Password Generation**) before following the steps in this section. Having an idea of what your new password should be beforehand will save time and avoid having to sign into the website again.

A Point of Confusion...

Also, be aware that changing passwords stored in items within 1Password does not change the passwords for the website/service/account it's meant for. 1Password is only a repository of information; they're recorded, just as you would if written to a text file or even a sticky note (though much more secure!). There is no connection (magical or otherwise) that will change the password for an account if you modify the password recorded in the 1Password item. The only way to change the password for your 1Password account is on the 1Password website, and the Item with your account info will not be updated automatically for you. That is why you must do it manually.

Step 1: Sign into your account on 1Password.com

For this you will need to open the Item in the 1Password app which contains your account info.



Tester Chester - 1Password
test@lanepds.org

Hover over the "website" field until the area is highlighted and you see the text "Open and fill" appear. Click it and a new browser tab will open and load the website for 1Password.



If your default web browser already has the 1Password browser extension (plug-in) installed on it, you should be automatically signed in and greeted with the following message.

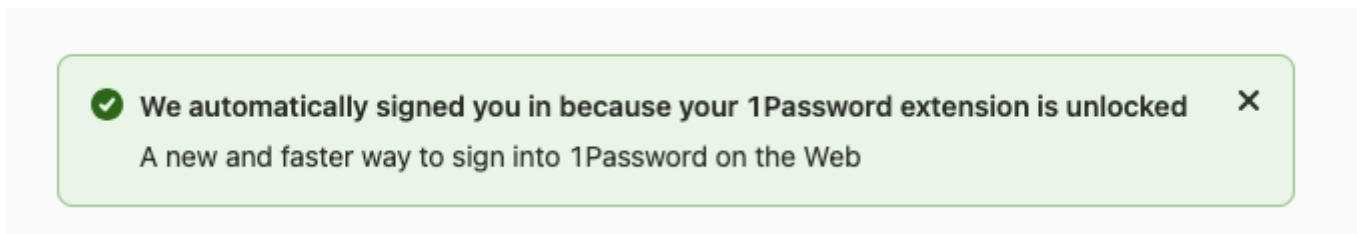

At this point if you see the above message, you can skip to [Step 2](#) and continue. However if you are greeted with the following web page, try **Option 1** or **Option 2**.

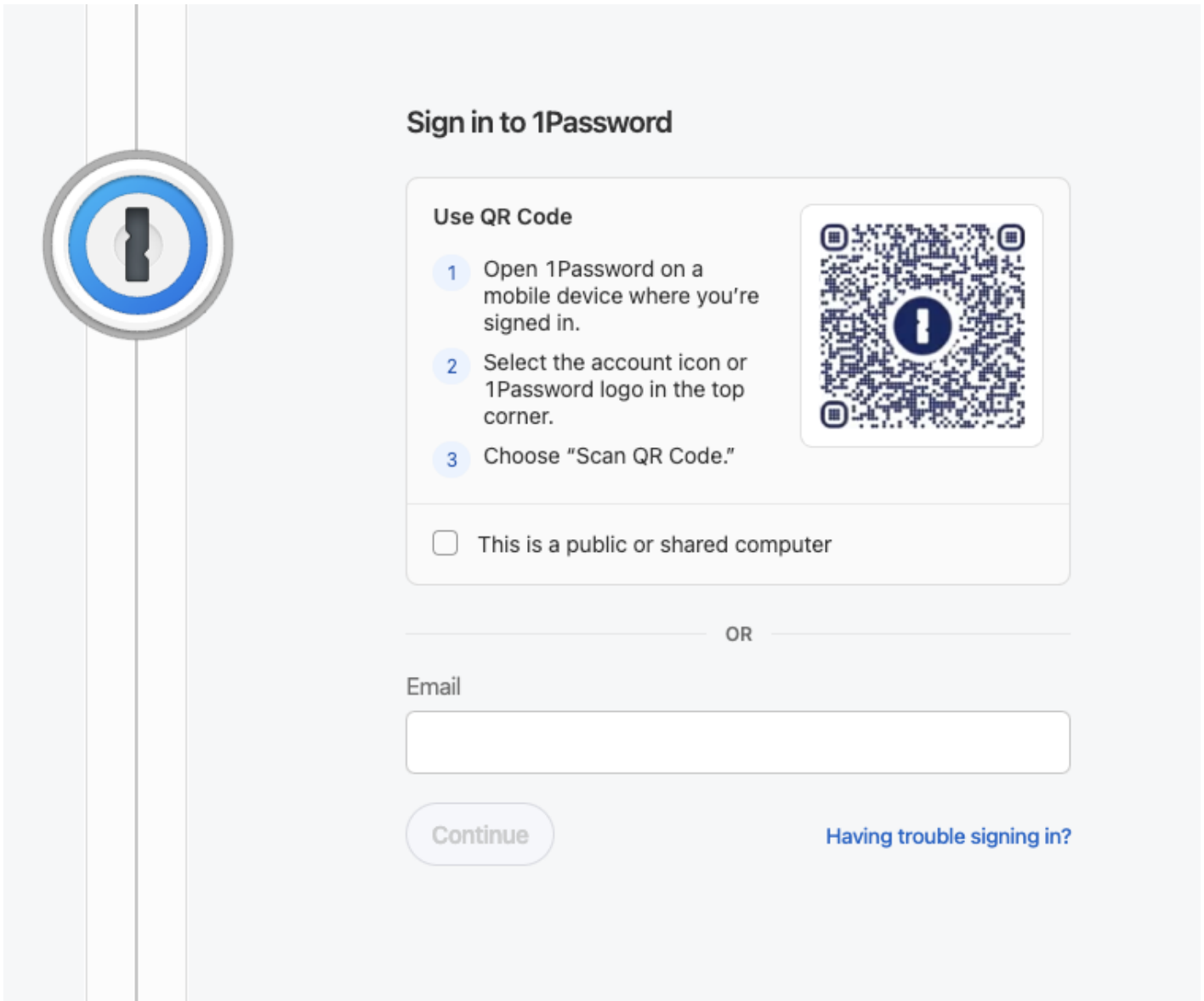

Option 1 - Scan the QR Code

If you've already got the 1Password app setup on your iPhone (covered in [Section 5](#)), you can scan the QR code that appears on the website using the 1Password app. Follow the instructions on the website or as follows:

1. Open 1Password on a mobile device where you're signed in.
2. Select the account icon or 1Password logo in the top corner.
3. Choose "Scan QR Code."

If successful, you should be logged into the website and you can skip to **Step 2** and continue.

Option 2 - Copy Account Details

If you've tried everything so far but it hasn't worked, this is the last method to try. It requires copying your account details from the Item in 1Password. There are 3 details to enter:

- Username (your email address)
- The Secret Key
- Password (your master password)

Click in the field for "Email" on the now loaded 1Password website. If the email address for the account doesn't autofill, copy the email address from the 1Password Item by hovering your mouse cursor over the "username" field until the text "Copy" appears, then click.



Paste the email address into the field on the webpage. Click "Continue" to proceed.

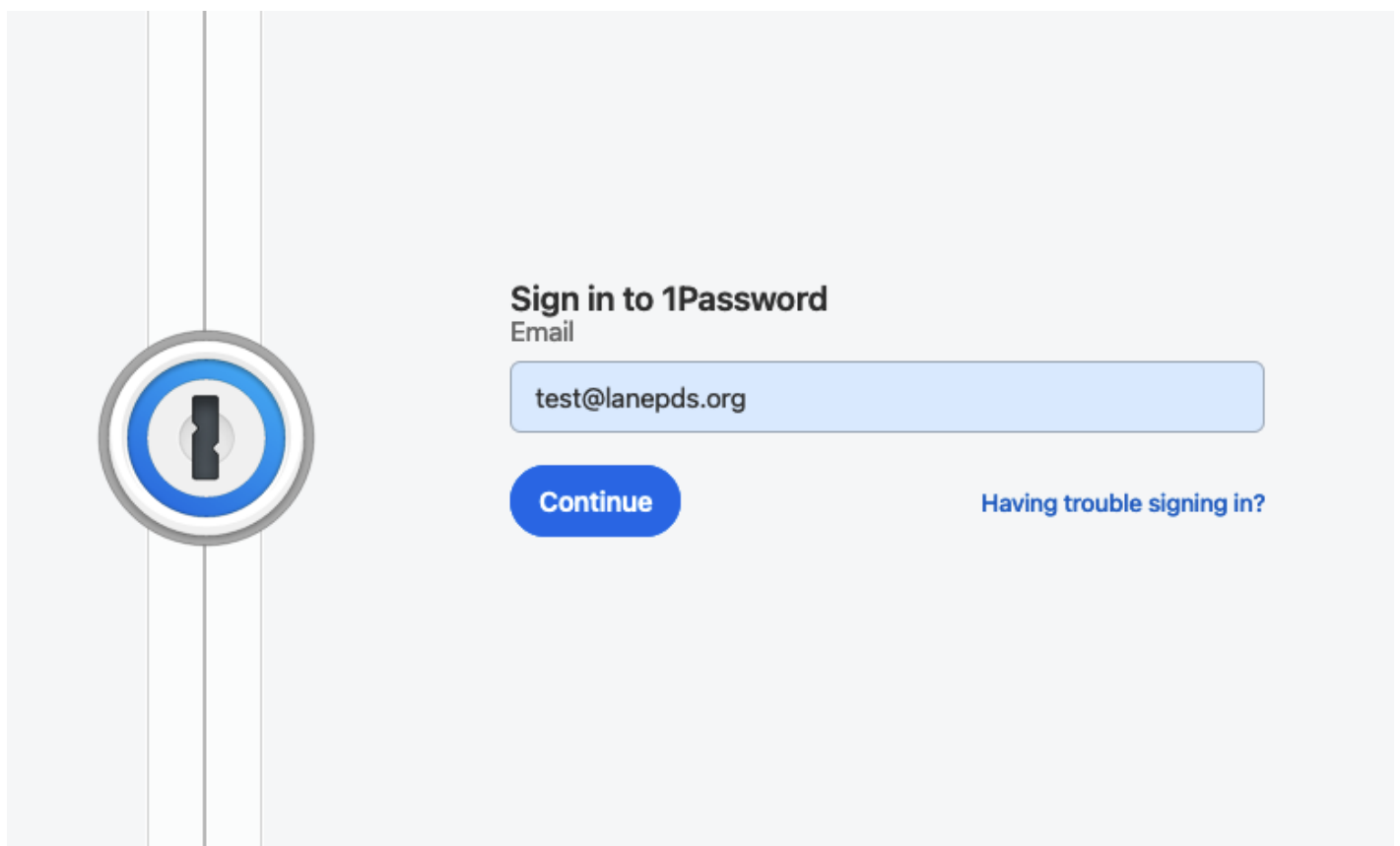

On the next page, you will see fields for "Email", "Secret Key", and "Password". Copy the "Secret Key" from the 1Password Item in the 1Password app and paste it into its respective field on the webpage. Type in your master password into the "Password" field and click "Sign In" to continue.



Sign in to your lanepds.1password.com account

Your account requires a Secret Key. You can find this in your Emergency Kit.

Email

test@lanepds.org

Secret Key [Find your Secret Key](#)

Password

This is a public or shared computer

[Sign In](#) [Having trouble signing in?](#)

“ **Note:**

You can ignore the message about an Emergency Kit. We do not use it.

If all else fails, contact IT for help.

Step 2: Click your name in the top right and choose "My Profile"

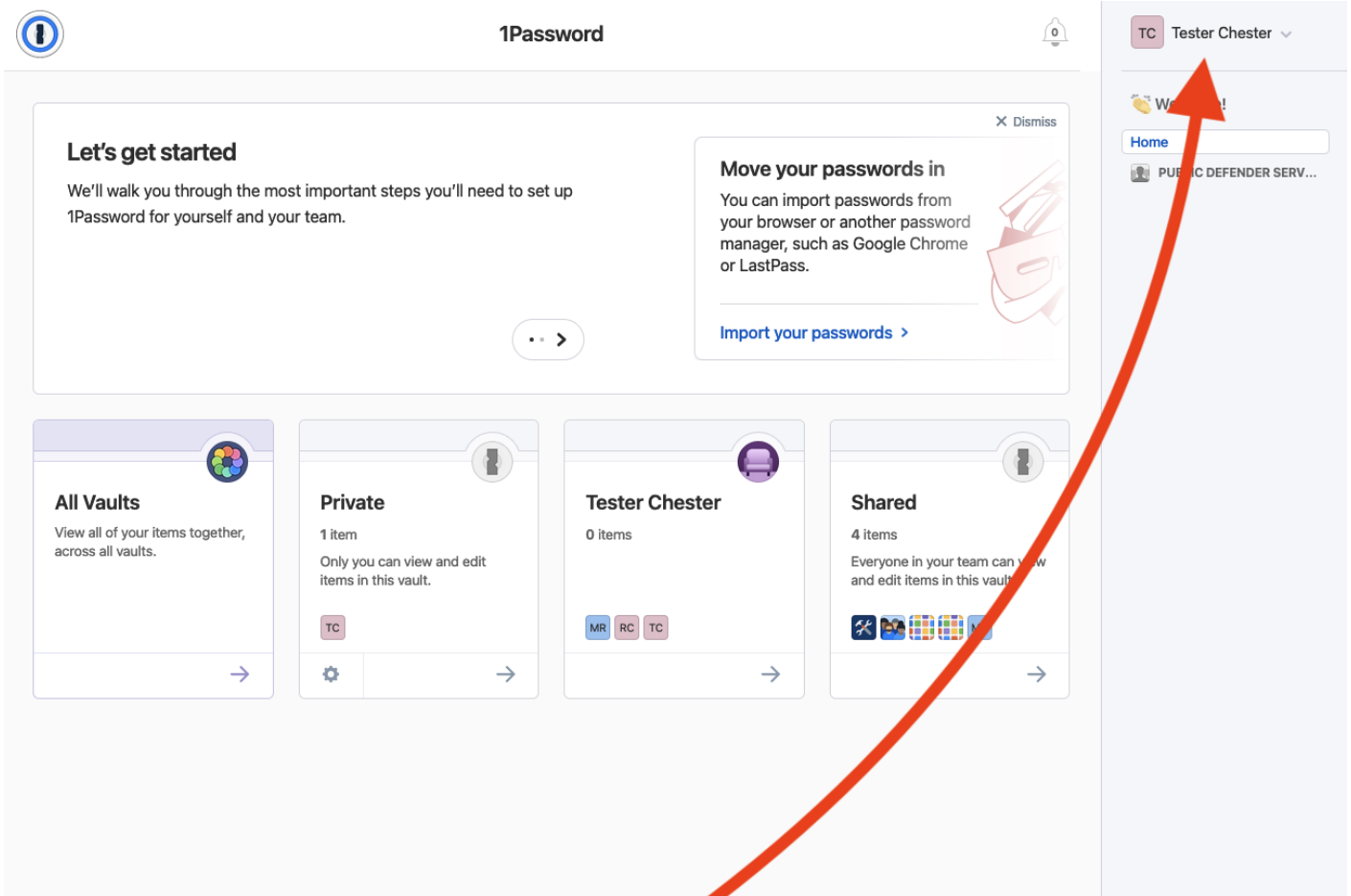

In the top right of the dashboard, you should see your name. Click on your name and a dropdown menu will appear. Click the option named "My Profile" and a new page will load.

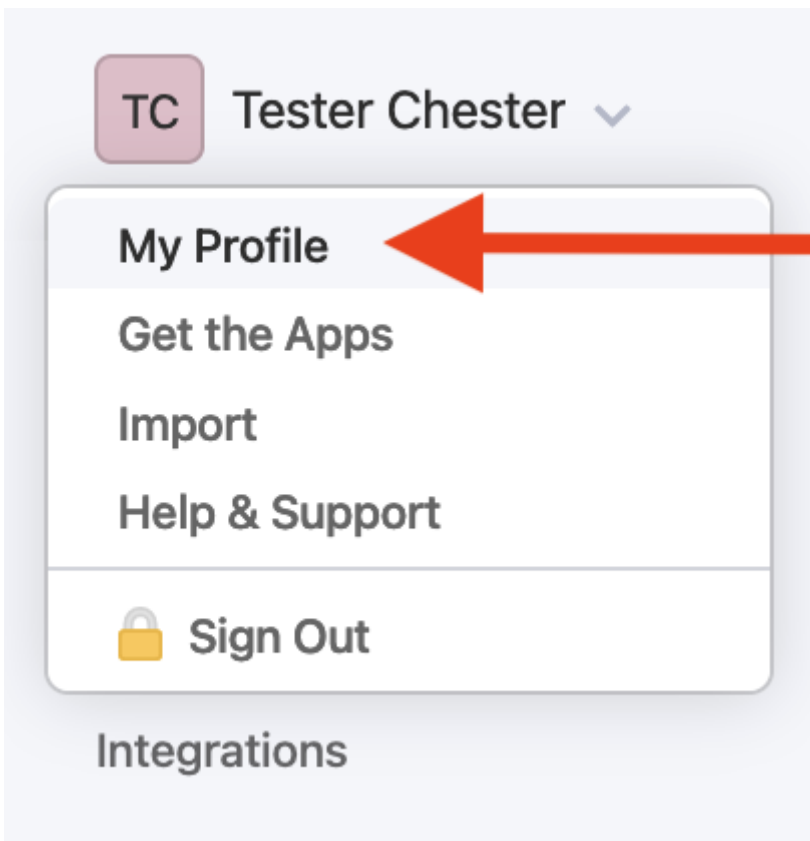

Step 3: Click "Change Password"

On the left side of the new page, click the button to "Change Password" to continue.

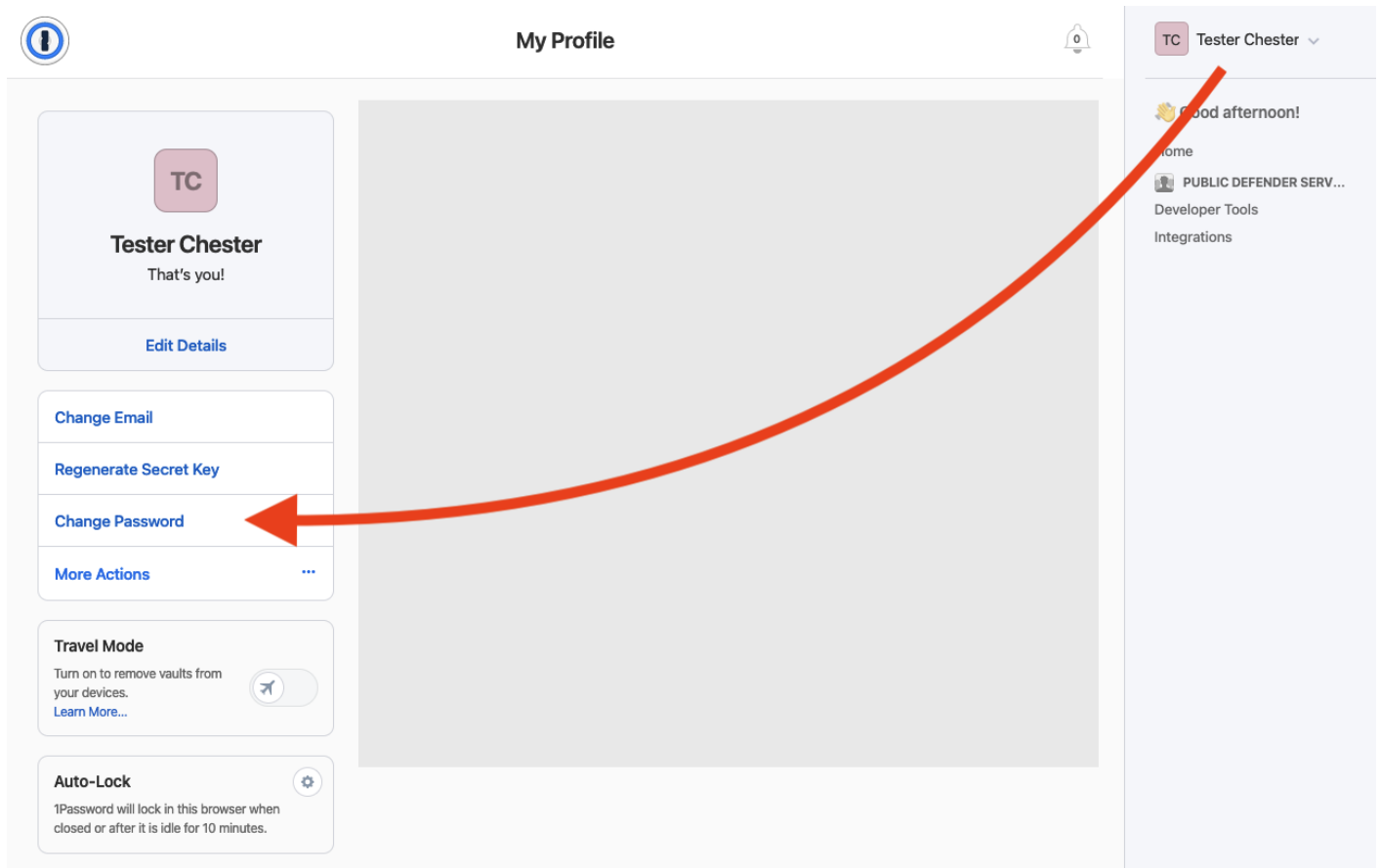

Step 4: Type in your current master password

Type in your current master password into the "Current Password" field.

Change Password

Close

Current Password

New Password



Enter a password. Make it random, but memorable.

Confirm New Password

Change Password

?

From this point on you will have less than 10 minutes to complete the process before the website logs you out. This timeout can be reset by closing the "Change Password" card, but anything entered will be lost.

Step 5: Edit your 1Password Item in the 1Password app

In the 1Password app — with the 1Password Item selected — click the "Edit" button.

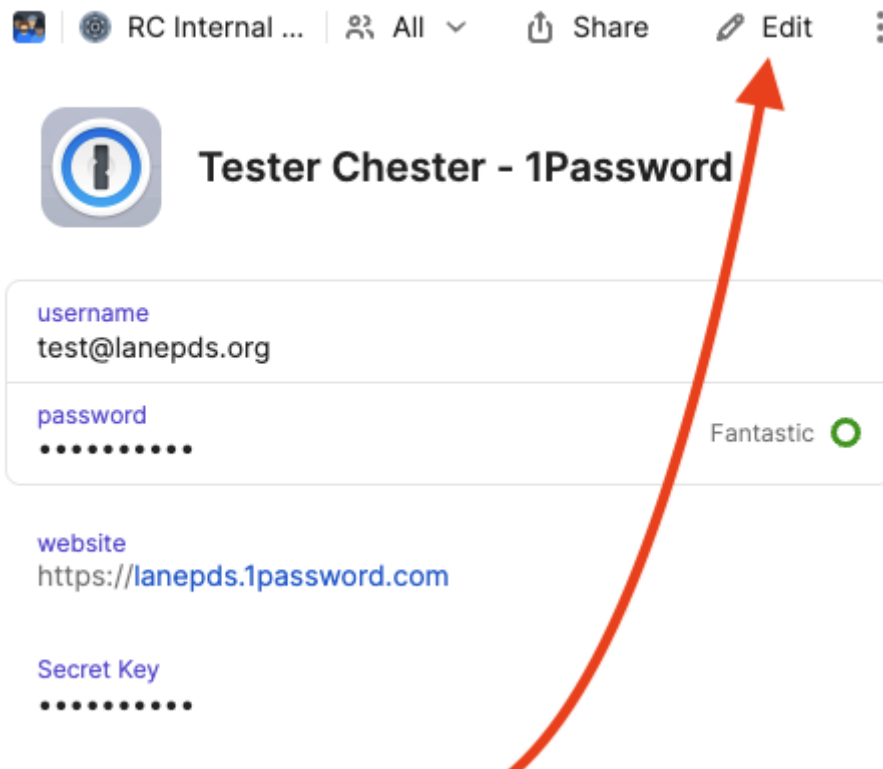

Step 6: Choose your new Master Password

?

Remember not to take too long choosing your password, or you will be logged out of the 1Password webpage.

Click in the password field of the 1Password Item, delete the present password, and then type in your new password. Optionally, you can use the "Create a New Password" feature, which is covered later in this step.

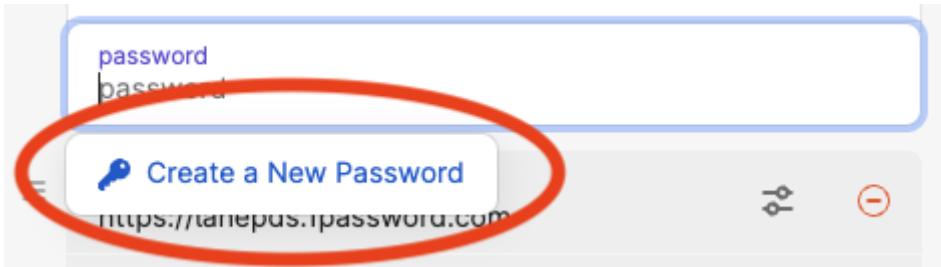

For more information on passwords, read the **Passwords and URLs** section of this guide.

Password Requirements

When creating your new password, you are free to type in any password you like provided it meets the following requirements:

- Your password must use 12 or more characters.
- Your password must include:
 - Uppercase letters (A B C D E F G ... etc)
 - Lowercase letters (a b c d e f g ... etc)
 - Symbols (, . ! @ # \$ % ... etc)
 - Numbers (1 2 3 4 5 ... etc)

Recommended Method

To make things easier, we recommend the following method for choosing a memorable and easy to type password:

- Choose 3 unrelated words that you can remember.
- Capitalize the first letter of one of the 3 words.
- Type each word, but separate them by a symbol, such as a or other symbol.
- Insert a 2 - 4 digit number somewhere in-between words.

Here is an example, but **please do not use this as your password**.

wordone.Wordtwo5555.wordthree

"Create a New Password" Feature (Optional)

When typing your new password, you may have noticed a button that appears below the field.

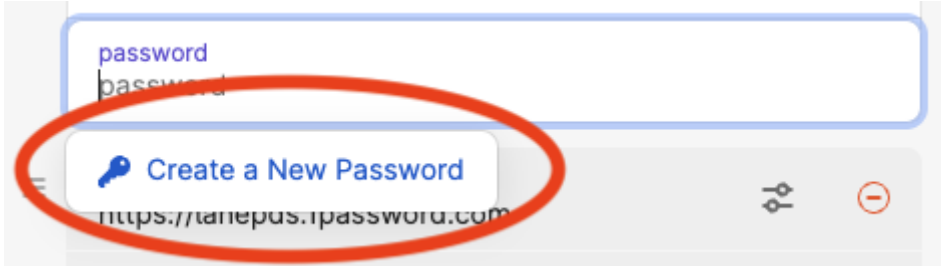

If you click this button, it will open a password generator that can create random passwords for you.

When creating passwords we recommend using these settings:

- Type: Memorable Password
- Words: 4
- Separator: Numbers and Symbols
- Capitalize:
- Full Words:

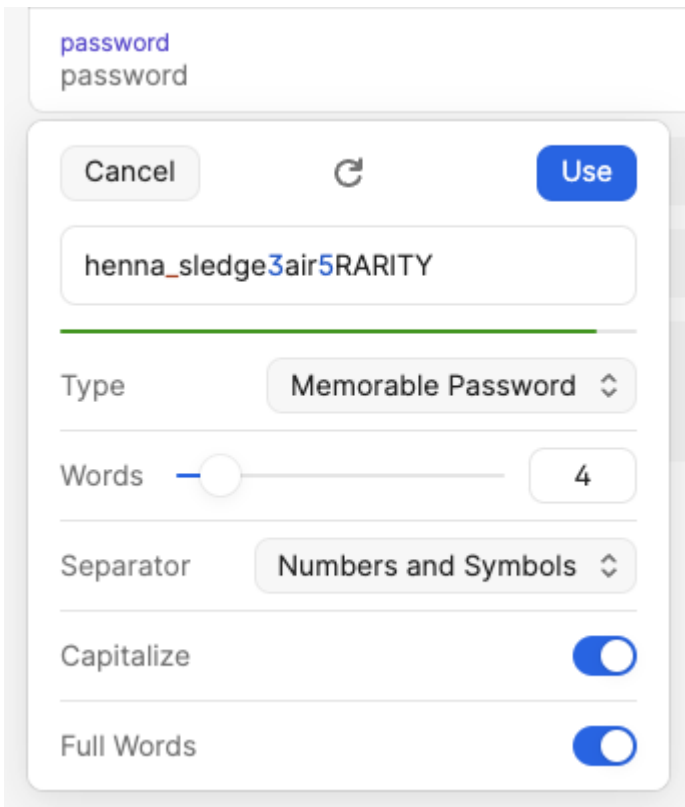

The circular arrow is a button to generate a new random password using the parameters that have been set below it. Each time it is clicked, a new password will be created. When you find something you like, click **Use** and it will close the password generator and place that password into the field. You can then modify it as needed. Just remember, it must still fulfill the requirements mentioned in the beginning of this step.

Step 7: Save Changes to your 1Password Item

Once you are satisfied with your new password, click the "Save" button. At this point, you've updated the Item for future reference. But remember, your password has not actually been updated for the 1Password account itself. You'll do that on the webpage we had open in **Step 4**.



Step 8: Copy Your New Password from the 1Password Item

Click the password field to copy the new password.



Switch back to your browser, where you should still have the Change Password prompt open.

It won't accept my new password! ?

If your new password did not meet all the requirements laid out at the beginning of Step 6, you may see a message under the New Password field that looks something like this:

New Password

 Add a symbol. Your current password doesn't meet your company's policy.

In this case you will need to go back to Step 5 and start again there. Create a new password, save it in the Item, and copy it to the webpage.

Finally click the blue "Change Password" button.

Step 8: Proceed to Section 6

You have now successfully changed your password. Please proceed to [Section 6](#).

Note that you should skip **Section 5** unless you haven't setup your iPhone yet. However, you are not required to setup your iPhone on your own; IT will handle that for you. If you have any questions, please contact IT for help.

Revision #32

Created 2023-11-10 18:44:37 UTC by Corban Monger

Updated 2025-02-14 20:25:50 UTC by Corban Monger